

DGS SERIES FILTERED SHORT-WAVE

SUBMITTAL DATA ELECTRIC INFRARED SPACE HEATERS

SUBMITTED BY: _____	DATE: _____
JOB TITLE: _____	CONTRACTOR: _____
ADDRESS: _____	PHONE #: _____
CITY: _____	ADDRESS: _____
STATE: _____ ZIP: _____	CITY: _____
ENGINEER: _____	STATE: _____ ZIP: _____
LOCAL REPRESENTATIVE: _____	PHONE: _____
	PHONE: _____

Qty.	Model Number	Volts	Watts	BTU	Amps	Typical Mounting Height ¹	Approx. Coverage	Approx. Watts per Square Foot	Weight
	DGS-Z1-A15	120	1,500	5,118	12.5	7 to 9 ft.	100 Sq. Ft.	4	5.7 lbs (2.6 kg)
	DGS-Z1-C20	230	2,000	6,824	8.7	7 to 9 ft.	100 Sq. Ft.	6	5.7 lbs (2.6 kg)
	DGS-Z2-C30	230	3,000	10,236	13.0	8 to 10 ft.	150 Sq. Ft.	8	9.7 lbs (4.4 kg)

¹Factory recommended mounting heights are listed as a guideline. If infrared heaters are mounted too low or too high, they may result in discomfort or lack of heat.

Material Type	Lamp Qty.	Voltage Code	Lamp Wattage Code	Lamp Type (Color)
Bronzed Extruded Aluminum	1	A = 120 VAC C = 230 VAC	15 = 1,500	Gold-Filtered Red
	2		20 = 2,000 30 = 3,000	

Model Configuration Example: DGS-Z1-A15



Available in 1,500 W or 2,000 W.

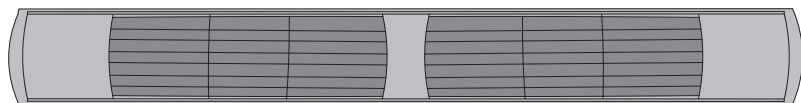

Available in 3,000 W comprised of two 1,500 W lamp elements.

DETROIT RADIANT PRODUCTS CO.



21400 Hoover Rd.
Warren, MI 48089-3162

Phone: (586) 756-0950
Fax: (586) 756-2626
Email: sales@irpatio.com
Website: www.irpatio.com



DGS SPECIFICATIONS

HEATER CONSTRUCTION

- Rustproof, extruded aluminum, bronze-colored body parts.
- IP55 water resistant for use in harsh conditions.
- Weatherproof - Heat is not affected by drafts, strong winds, or rain.
- High-end quality and compact, aesthetic design.

REFLECTORS

- Custom designed parabolic reflector reflects 99% of rays directly towards target. visible light glare.

LAMP ELEMENTS

- Gold-filtered red.
- Instant heat-up to 3,500°F in 2 seconds.
- Long lamp life and heat sensitivity.

MOUNTING

- 0° to 45° adjustable brackets.
- Universal burning position operates in all installation angles for ultimate versatility.

CONTROLS

- Field supplied.

ELECTRICAL SUPPLY

- Voltages from 120 to 230 VAC.
- Single-phase.
- 1,500 to 2,000W per element.

APPROVALS

- CE Certified for indoor and outdoor applications.
- Commercial/Industrial Approval.



LIMITED WARRANTY

- All components - 1 year.
- Please contact the factory for further information on the terms and conditions.*

FIELD DATA

DIMENSIONAL INFORMATION

FRONT VIEW

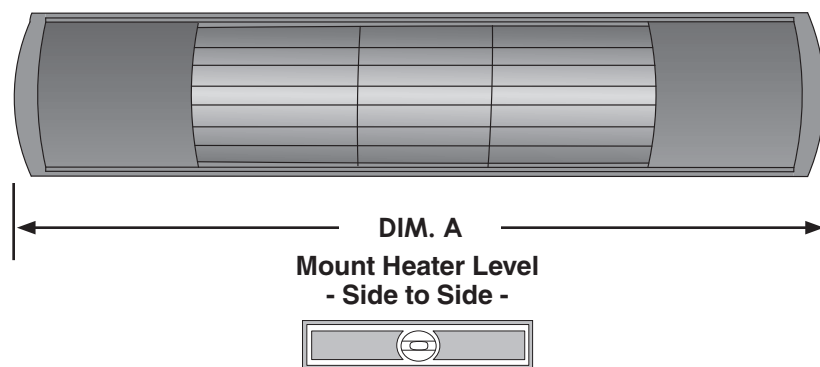

END VIEW

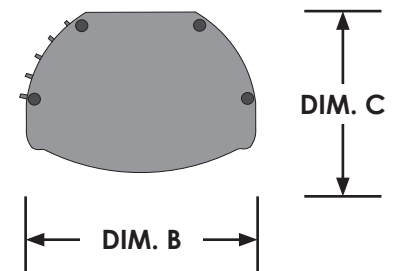

MODEL NUMBER	DIM A INCHES (MM)	DIM B INCHES (MM)	DIM C INCHES (MM)
DGS-Z1-A15	21.06 (535)	4.84 (123)	4.61 (117)
DGS-Z1-C20	21.06 (535)	4.84 (123)	4.61 (117)
DGS-Z2-C30	36.75 (933)	4.84 (123)	4.61 (117)

CLEARANCES TO COMBUSTIBLES (IN.)

WATTAGE RANGE	MOUNTING ANGLE	SIDE		END	TOP	BELOW
		FRONT	BEHIND ¹			
1,500	0°	24	24	24	6	40
	45°	40	24	24	10	40
2,000	0°	24	24	24	6	46
	45°	46	24	24	10	46
3,000	0°	24	24	24	6	56
	45°	56	24	24	10	56

*A minimum clearance of 36 inches must be maintained from behind another heater.

NOTE: Ensure that building materials with a low heat tolerance (i.e, awnings, fabrics, plastics, sprinklers, insulation, etc.) are protected against degradation. This may require the heater to be mounted at a distance in excess of the published clearances to combustibles. Contact the material manufacturer for specific details.

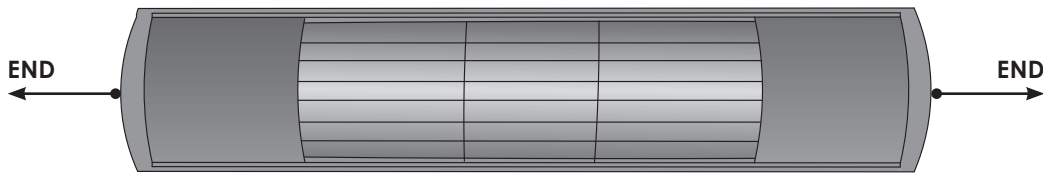

FRONT VIEW - 0° Mounting Angle

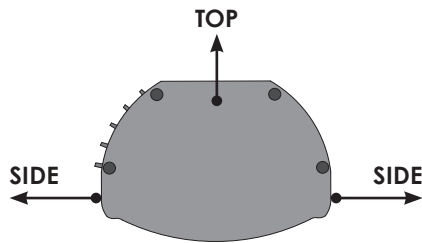

END VIEW 0° - Mounting Angle

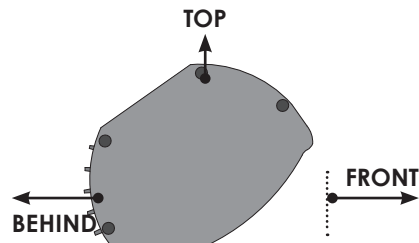

END VIEW - 1° to 45° Mounting Angle

OPTIONAL ACCESSORIES

QTY.	PART NO.	DESCRIPTION	NOTES

WRITTEN SPECIFICATIONS

DGS SERIES INFRARED HEATER PARAMETER/SPECIFICATIONS

- Filtered short-wave electric infrared heaters shall be furnished and installed in accordance with governing codes and as shown per drawing(s) provided. Medium wave electric heaters shall be **RE-VERBER-RAY DGS SERIES**, as manufactured by Detroit Radiant Products Company, Warren, MI 48089.
- Filtered short-wave infrared heaters shall be Designed Certified by CE and bear the CE Seal of Certification for the United States and Canada.
- The supplier shall provide manufacturer's published warranty covering all components utilized in the heater control assembly for a period of one (1) year.
- The supplier shall furnish the owner/contractor with _____ copies of the engineering specification form, showing physical dimensions, installation detail, recommendations, wiring diagrams, and spare parts list.
- An Installation, Operation, Maintenance and Parts Manual (IOPM) shall be supplied with each heater.
- The manufacturer shall have a minimum of 50 years of manufacturing experience producing infrared heaters.
- Filtered short-wave infrared heaters must be CE Listed to operate at the designated rating of _____ kW/h.
- Filtered short-wave infrared space heaters shall be supplied and installed in accordance with the manufacturers certified installation instructions and governing codes, as shown per building drawing(s) _____. Heaters shall be DGS Series, model numbers, input ranges in Watts.

DGS SERIES INFRARED HEATER CONTROLS

- Field supply applicable controls.
- Heaters shall operate in given voltages:

<u>Volt</u>	<u>Phase</u>	<u>Hertz</u>
120V	1ph	50/60
230V	1ph	50/60

- Heaters shall operate in given wattage inputs of 1,500 to 3,000.

DGS SERIES INFRARED HEATER CONSTRUCTION

- The heater housing shall be constructed of aluminum with bronze-colored and gold-filtered red lamps.
- The emitter tubing shall be argon filled evacuated blown quartz with high temperature ceramic end caps.
- Factory supplied mounting brackets shall accommodate for sidewall or ceiling mounting.